

272415

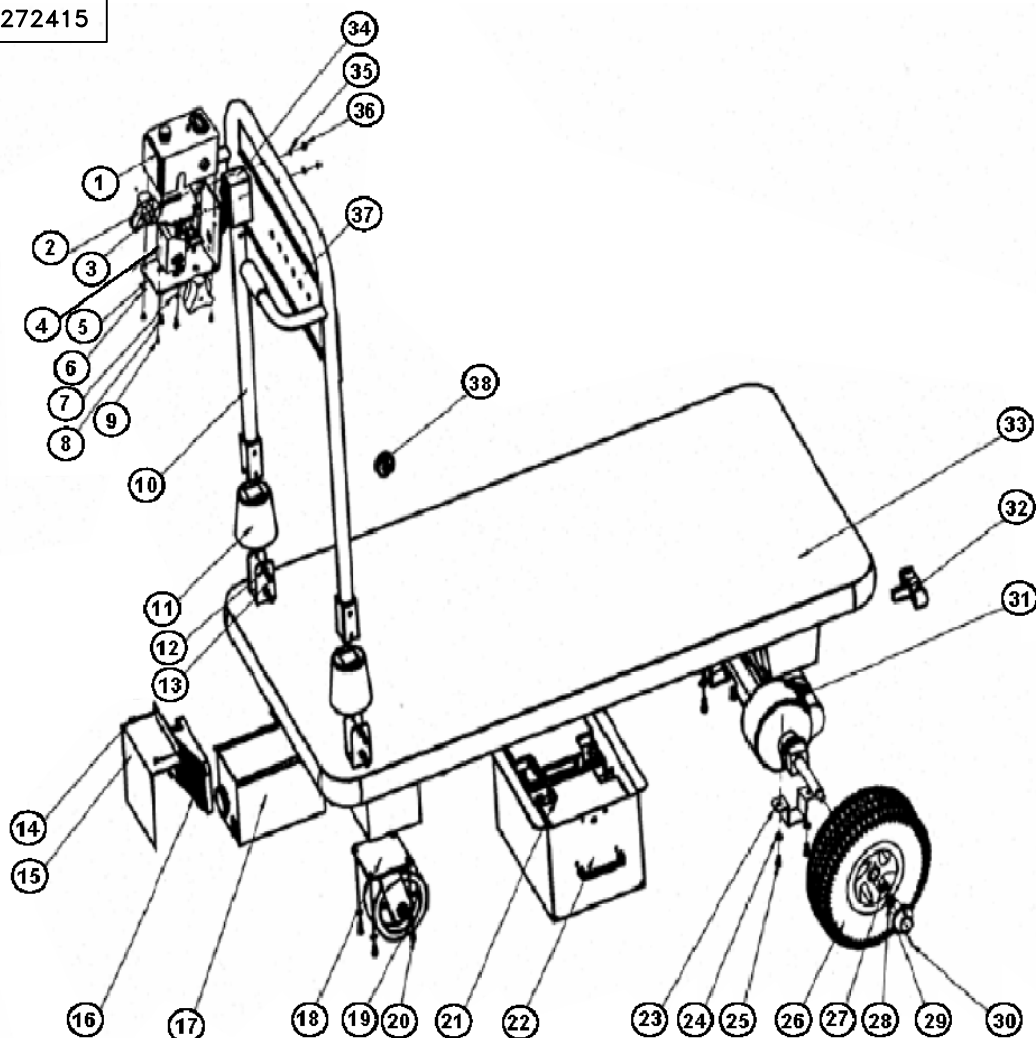

## POWER DRIVE PLATFORM TRUCKS

- 47-1/4" turning radius.
- Deck height from floor: 12.375".
- Finger tip variable speed controller with forward and reverse modes. Illuminated battery status indicator.
- Key lock and emergency stop.
- Motor: 370 watts.
- Maximum climbing incline: 8 degrees.
- (2) 12V 40 A.H. batteries and charger included.
- Charge time: 7-8 hr.
- Continuous run time: 6 hr.
- Motor controller: Curtis 110 amp.
- Front wheels: 10" pneumatic.
- Rear swivel polyurethane casters: 5" x 2".
- Reverse direction safety beeper and reduced speed in reverse for added safety.
- Full perimeter bumper helps prevent wall damage.
- Rear panel grid helps keep cargo in place.
- Durable white powder coat finish with black rubber deck mat.
- 43" handle height.
- Steel thickness 2.5 mm.

P/N 272415  
 Capacity: 1,100 lbs  
 Shelf Size: 30" x 48"  
 Casters: 5" x 2"  
 Wheel Type: 10" Pneumatic  
 Weight: 276 lbs

## NOTES:

Item 10 & Item 37 sold as Handle Replacement Kit (P/N 272428). No switches or controls included. Fits both 24" & 30" wide platforms.

## REPLACEMENT PARTS LIST

ITEM	PART NO.	DESCRIPTION	QTY.
A 1	SEE BELOW	SWITCH BOX	1
A 2	SEE BELOW	SPEED ADJUST HANDLE	2
3		M6X38 HEX SCREW	2
A 4	SEE BELOW	ACCELERATOR	1
5		SWITCH PLATE	1
6		4MM WASHER	4
7		5MM WASHER	2
8		M5X10 HEX SCREW	2
9		M4X10 HEAD SCREW	4
B 10	272428	REPLACEMENT HANDLE	1
11	272430	HANDLE SHELF BOTTOM COVER	2
12	272431	8MM WASHER	8
13	272432	M8X15 HEX SCREW	8
14	272433	M5X10 HEAD SCREW	2
15	272434	CONTROLLER COVER	1
16	272435	CONTROLLER	1
17	272426	CHARGER BOX	1
18	272436	CASTER	2
19	272431	8MM WASHER	8
20	272437	M8X20 HEX SCREW	8
21	272438	BATTERY	2
22	272439	BATTERY BOX	1
23	272440	TRANSAXLE FIXTURE	2
24	272431	8MM WASHER	4
25	272437	M8X20 HEX SCREW	4
26	272441	FRONT WHEEL	2
27	272442	10MM WASHER	2
28	272443	M10 LOCKNUT	2
29	272444	FRONT WHEEL COVER	2
30	272445	M3X10 HEAD SCREW	4
31	272446	REPLACEMENT MOTOR	1
32	272448	BRAKE HANDLE	1
33	272449	CART UNDERPAN	1
34	272450	CHARGER SOCKET	1
35	272481	6MM WASHER	2
36	272482	M6 CUP NUT	2
B 37	272428	HANDLE PLATE	1
38	272485	BATTERY BOX FIX HANDLE	1

## ADDITIONAL OFFERED PARTS

	272459	WIRING HARNESS	1
	272487	FUSE	1
B	272428	HANDLE REPLACEMENT KIT (INCLUDES ITEMS 10 & 37)	1

PARTS FOR "OLD" MODELS MANUFACTURED BEFORE 05/2018				PARTS FOR "NEW" MODELS MANUFACTURED AFTER 05/2018			
	272569	CIRCUIT BOARD	1		272422	CIRCUIT BOARD	1
A	272568	COMPLETE SWITCH BOX KIT (INCLUDES ITEMS BELOW)	1	A	272427	COMPLETE SWITCH BOX KIT (INCLUDES ITEMS BELOW)	1
	272564	EMERGENCY BRAKE BUTTON	1		272594	EMERGENCY BRAKE BUTTON	1
	272566	POTENTIOMETER	1		272595	POTENTIOMETER	1
	272567	THROTTLE	1		272596	THROTTLE	1
	272424	KEY SWITCH & KEY SET	1		272597	KEY SWITCH & KEY SET	1

THIS DRAWING IN ALL PARTICULARS IS WESCO INDUSTRIAL PRODUCTS, LLC PROPERTY. ALL RIGHTS OF DESIGN, INVENTION OR USE OF ARE RESERVED.

PRINT ISSUED

AUG. 12, 2019

WESCO MANUFACTURING  
ENGINEERING DEPARTMENTWESCO INDUSTRIAL PRODUCTS, LLC  
NORTH WALES  
PENNA. 19454

PART NAME  PLATFORM TRUCK: POWERED 30" x 48"		DRAWN:	
		CHECKED:	
TOLERANCE UNLESS OTHERWISE SPECIFIED		APP. ENGR.	
FRACTION                      3 PLACE DECIMAL                      2 PLACE DECIMAL		SCALE:                      1" = 1"	
± 1/64                      ± .005                      ± .01			
ANGULAR ± 1-1/2°                      SHEET                      1                      OF                      1			
BREAK ALL SHARP EDGES AND REMOVE ALL BURRS		B- 272415	
		REV	A