

272414

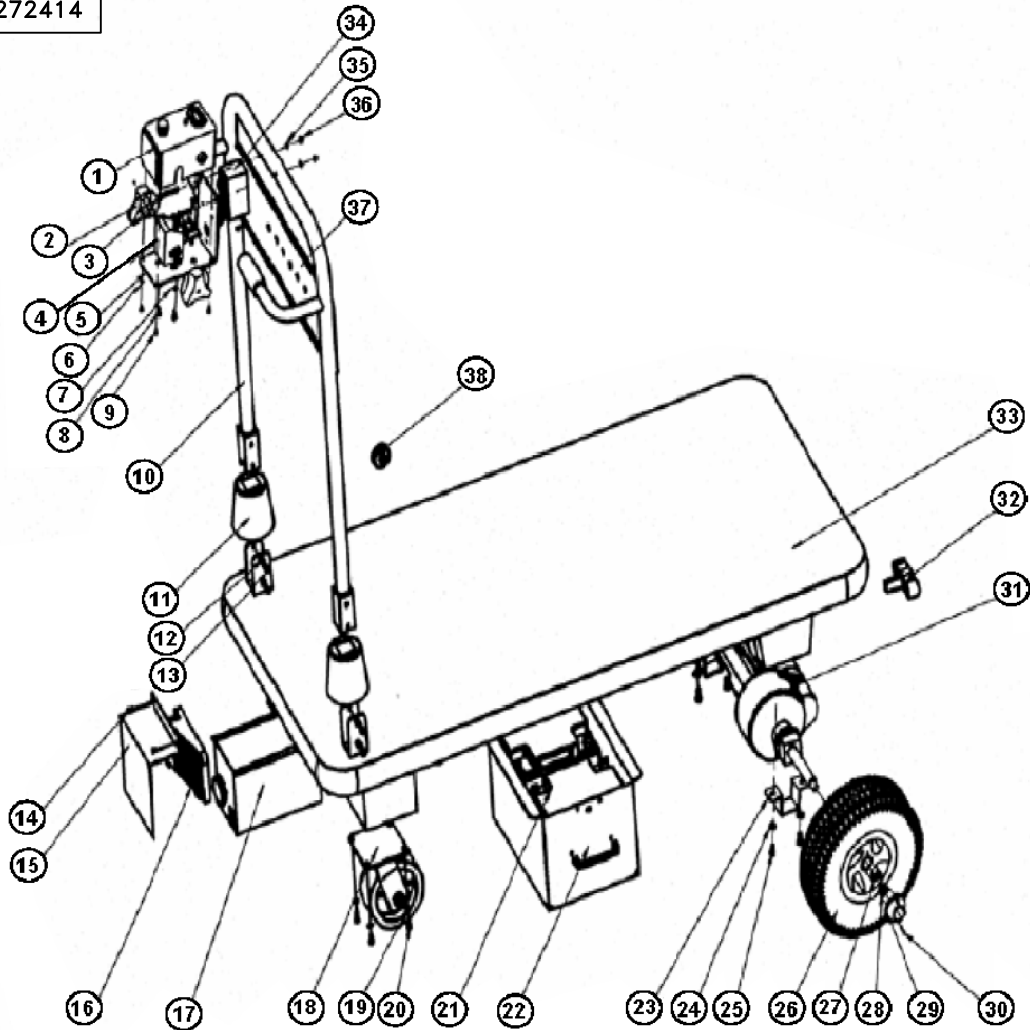

POWER DRIVE PLATFORM TRUCKS

- 47-1/4" turning radius.
- Deck height from floor: 12.375".
- Finger tip variable speed controller with forward and reverse modes. Illuminated battery status indicator.
- Key lock and emergency stop.
- Motor: 370 watts.
- Maximum climbing incline: 8 degrees.
- (2) 12V 40 A.H. batteries and charger included.
- Charge time: 7-8 hr.
- Continuous run time: 6 hr.
- Motor controller: Curtis 110 amp.
- Front wheels: 10" pneumatic.
- Rear swivel polyurethane casters: 5" x 2".
- Reverse direction safety beeper and reduced speed in reverse for added safety.
- Full perimeter bumper helps prevent wall damage.
- Rear panel grid helps keep cargo in place.
- Durable white powder coat finish with black rubber deck mat.
- 43" handle height.
- Steel thickness 2.5 mm.

P/N 272414
Capacity: 1,100 lbs
Shelf Size: 24" x 48"
Casters: 5" x 2"
Wheel Type: 10" Pneumatic
Weight: 254 lbs

NOTES:
Item 10 & Item 37 sold as Handle Replacement Kit (P/N 272428). No switches or controls included. Fits both 24" & 30" wide platforms.

| REPLACEMENT PARTS LIST | | | |
|--------------------------|----------|---|------|
| ITEM | PART NO. | DESCRIPTION | QTY. |
| A | 1 | SEE BELOW SWITCH BOX | 1 |
| A | 2 | SEE BELOW SPEED ADJUST HANDLE | 2 |
| | 3 | M6X38 HEX SCREW | 2 |
| A | 4 | SEE BELOW ACCELERATOR | 1 |
| | 5 | SWITCH PLATE | 1 |
| | 6 | 4MM WASHER | 4 |
| | 7 | 5MM WASHER | 2 |
| | 8 | M5X10 HEX SCREW | 2 |
| | 9 | M4X10 HEAD SCREW | 4 |
| B | 10 | 272428 REPLACEMENT HANDLE | 1 |
| | 11 | 272430 HANDLE SHELF BOTTOM COVER | 2 |
| | 12 | 272431 8MM WASHER | 8 |
| | 13 | 272432 M8X15 HEX SCREW | 8 |
| | 14 | 272433 M5X10 HEAD SCREW | 2 |
| | 15 | 272434 CONTROLLER COVER | 1 |
| | 16 | 272435 CONTROLLER | 1 |
| | 17 | 272426 CHARGER BOX | 1 |
| | 18 | 272436 CASTER | 2 |
| | 19 | 272431 8MM WASHER | 8 |
| | 20 | 272437 M8X20 HEX SCREW | 8 |
| | 21 | 272438 BATTERY | 2 |
| | 22 | 272439 BATTERY BOX | 1 |
| | 23 | 272440 TRANSAXLE FIXTURE | 2 |
| | 24 | 272431 8MM WASHER | 4 |
| | 25 | 272437 M8X20 HEX SCREW | 4 |
| | 26 | 272441 FRONT WHEEL | 2 |
| | 27 | 272442 10MM WASHER | 2 |
| | 28 | 272443 M10 LOCKNUT | 2 |
| | 29 | 272444 FRONT WHEEL COVER | 2 |
| | 30 | 272445 M3X10 HEAD SCREW | 4 |
| | 31 | 272446 REPLACEMENT MOTOR | 1 |
| | 32 | 272448 BRAKE HANDLE | 1 |
| | 33 | 272449 CART UNDERPAN | 1 |
| | 34 | 272450 CHARGER SOCKET | 1 |
| | 35 | 272481 6MM WASHER | 2 |
| | 36 | 272482 M6 CUP NUT | 2 |
| B | 37 | 272428 HANDLE PLATE | 1 |
| | 38 | 272485 BATTERY BOX FIX HANDLE | 1 |
| ADDITIONAL OFFERED PARTS | | | |
| | 272459 | WIRING HARNESS | 1 |
| | 272487 | FUSE | 1 |
| B | 272428 | HANDLE REPLACEMENT KIT (INCLUDES ITEMS 10 & 37) | 1 |

| PARTS FOR "OLD" MODELS MANUFACTURED BEFORE 05/2018 | | | | PARTS FOR "NEW" MODELS MANUFACTURED AFTER 05/2018 | | | |
|---|--------|--|---|--|---------------|--|---|
| | 272569 | CIRCUIT BOARD | 1 | 272422 | CIRCUIT BOARD | 1 | |
| A | 272568 | COMPLETE SWITCH BOX KIT (INCLUDES ITEMS BELOW) | 1 | A | 272427 | COMPLETE SWITCH BOX KIT (INCLUDES ITEMS BELOW) | 1 |
| | 272564 | EMERGENCY BRAKE BUTTON | 1 | | 272594 | EMERGENCY BRAKE BUTTON | 1 |
| | 272566 | POTENTIOMETER | 1 | | 272595 | POTENTIOMETER | 1 |
| | 272567 | THROTTLE | 1 | | 272596 | THROTTLE | 1 |
| | 272424 | KEY SWITCH & KEY SET | 1 | | 272597 | KEY SWITCH & KEY SET | 1 |

THIS DRAWING IN ALL PARTICULARS IS WESCO INDUSTRIAL PRODUCTS, LLC PROPERTY. ALL RIGHTS OF DESIGN, INVENTION OR USE OF ARE RESERVED.

PRINT ISSUED

AUG. 12, 2019

WESCO MANUFACTURING
ENGINEERING DEPARTMENT

| | | | | |
|------|------------|----------|---|-----------------|
| REV. | ECN & DATE | APPROVED | WESCO INDUSTRIAL PRODUCTS, LLC NORTH WALES PENNA. 19454 | |
| | | | PART NAME PLATFORM TRUCK: POWERED 24" x 48" | DRAWN: |
| | | | TOLERANCE UNLESS OTHERWISE SPECIFIED | CHECKED: |
| | | | FRACTION 3 PLACE DECIMAL 2 PLACE DECIMAL | APP. ENGR. |
| | | | ± 1/64 ± .005 ± .01 | SCALE: 1" = 1" |
| | | | ANGULAR ± 1-1/2° SHEET 1 OF 1 | B- 272414 REV A |
| | | | BREAK ALL SHARP EDGES AND REMOVE ALL BURRS | |